



Enhancement of the existing neutral grassland through reseeded. To be reseeded with either BFS 3 – Floodplain Meadow Grassland Seed Mix by Phoenix Amenity Supplies or EM4 Meadow Mixture for Clay Soils by Emorsgate Seeds Ltd, depending on more detailed soil / ground analysis.

Existing SUDs pool basin to be connected to the wider drainage system in this phase of works to provide drainage to the new pitches. The basin is to be reseeded with either BFS 3 – Floodplain Meadow Grassland Seed Mix by Phoenix Amenity Supplies, EM8 Meadow Mixture for Wetlands by Emorsgate Seeds Ltd or SuDS Turf by Wildflower Turf Ltd laid on a topsoil bed, depending on more detailed soil / ground analysis.

Enhancement of the existing mixed woodland to improve the condition for Biodiversity Net Gain purposes. In summary this would be:

- A thinning regime should be implemented to encourage new growth and establish a good woodland structure, e.g., canopy, understory, ground flora.
- Young trees should be planted to supplement natural regeneration (if required) with a variety of native species of local provenance. Five or more native species in the woodland parcels are required to achieve a 'good' BNG condition.
- Remove damaged or undertake remediation works trees.
- Monitored on a regular basis to ensure no invasive species establish themselves.

More detail is to be prescribed in any future Landscape and Ecological Management Plan (LEMP).

Existing lowland acid grassland retained and untouched where possible. Refer to Biodiversity Net Gain Report for further information.

Existing SUDs swale basin moved and reformed to satisfy comments from Highways for the new access road. The exact location and design is to be confirmed in the detailed design stage for drainage works. The area where earthworks is to occur is to be seeded with with either BFS 3 – Floodplain Meadow Grassland Seed Mix by Phoenix Amenity Supplies, EM8 Meadow Mixture for Wetlands by Emorsgate Seeds Ltd or SuDS Turf by Wildflower Turf Ltd laid on a topsoil bed, depending on more detailed soil / ground analysis. There is to be plug planting to the centre of the swale basin for Biodiversity Net Gain purposes. A suggested list of species that are water inundation-tolerant are:

- Veronica beccabunga (Brooklime)
- Lysimachia nummularia (Creeping Jenny)
- Carex aucuparia (Lesser pond sedge)
- Ranunculus flammula (Lesser spearwort)
- Caltha palustris (Marsh-marigold)
- Juncus effusus (Soft rush)
- Myosotis scorpioides (Water forget-me-not)

Plant up to 250mm above anticipated normal water level as plugs in groups of 5-10Nr plants to create stands. Planted at 8 plugs/m<sup>2</sup>

The above list is not exhaustive and subject to more detailed survey work and design.

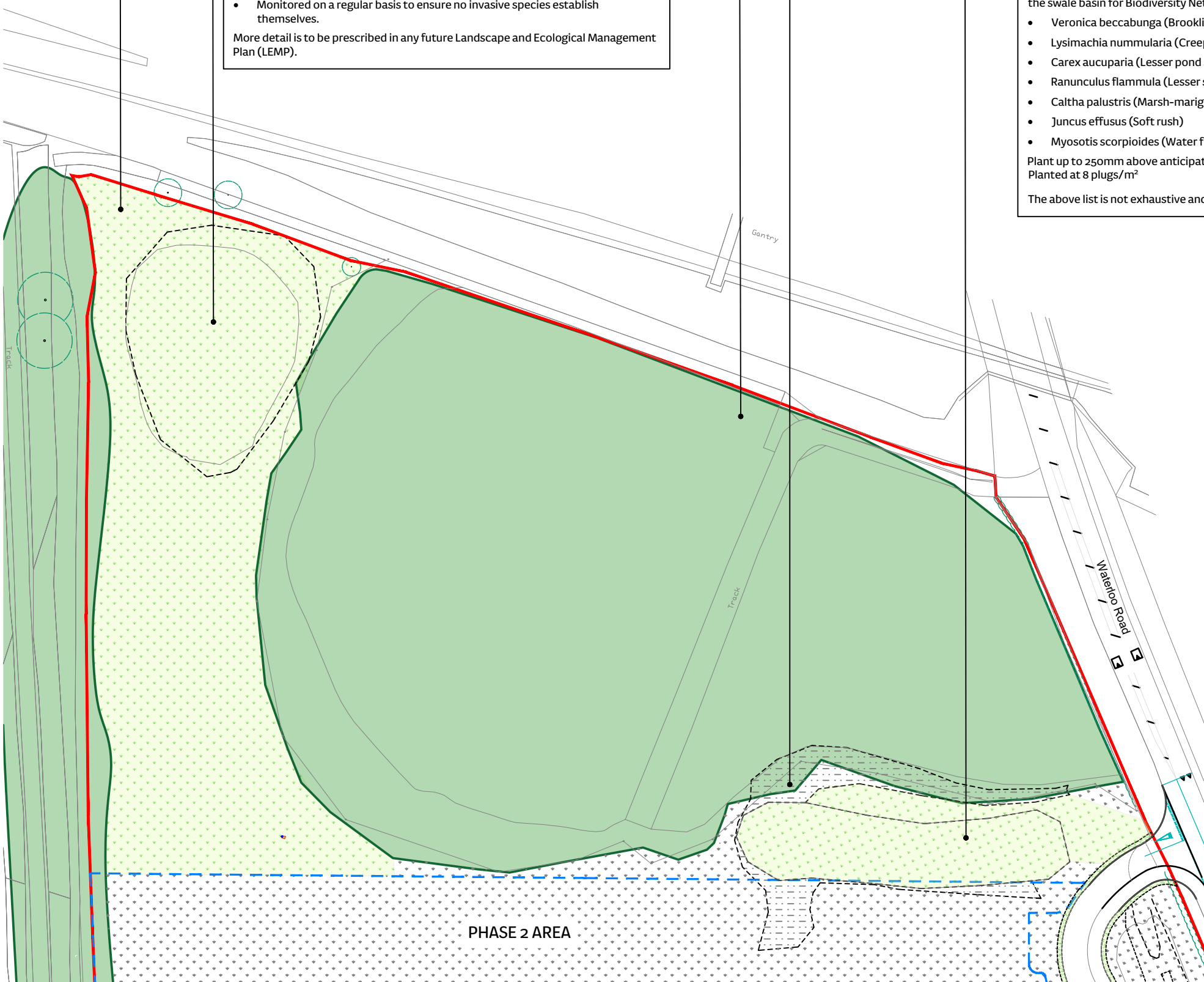

SOFT LANDSCAPE STRATEGY LEGEND

Individual tree planting to provide additional BNG habitat. This area of Telford is considered 'moderate' priority for tree planting; to increase the current 21% tree canopy cover to a goal of 30%. To be double staked for standard trees and triple staked for multi stem trees. Locations are subject to below ground services final positions. Refer to labels on this drawing for tree species size and schedule on drawing 518.22.L03 for suggested tree species list and specification.

Proposed native blackthorn scrub planting to compensate for the loss of habitat, refer to the BNG report for additional information. Refer to schedule on drawing 518.22.L03 for suggested species and specification. To provide screening and habitat connectivity along the south and east boundaries.

Proposed native hedge planting to provide +10% in BNG for linear features, refer to the BNG report for additional information. Refer to schedule on drawing 518.22.L03 for suggested species and specification.

Proposed ornamental planting to car park area and new pavilion approach. Refer to schedule on drawing 518.22.L03 for suggested species and specification.

SEEDING AND TURFING

Wildflower seeding or turfing. To enhance the existing grassland habitat to provide a 'neutral grassland', refer to BNG report for additional information. Refer to labels on this drawing for seeding mix and turfing options. To be mown once annually.

Amenity grass seeding. A seed mix to provide a suitable playing pitch grass surface and margins for amenity purposes. To be mown regularly.

EXISTING LANDSCAPE FEATURES TO BE PROTECTED

Existing tree group retained. Refer to Tree Constraints and Arboricultural Impact Report by Red Kite for further information including tree removal and tree protection.

Existing individual tree retained. Refer to Tree Constraints and Arboricultural Impact Report by Red Kite for further information including tree removal and tree protection.

Existing hedge retained.

Existing grassland retained.

Key Plan:

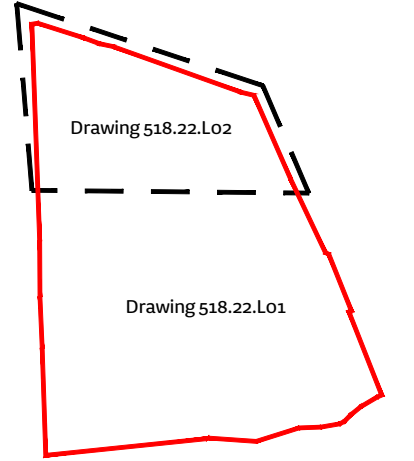

Notes:  
To be read in conjunction with the most recent revisions of:

- Biodiversity Net Gain Feasibility Report by Red Kite
- Tree Constraints and Arboricultural Impact Report Revision A (9<sup>th</sup> February 2022) by Red Kite
- Drawing A\_00104 Phase 1 - Masterplan by biT

Rev A	Final issue for planning submission	09.04.24	KL	NH
-------	-------------------------------------	----------	----	----

CLIENT:

biT

PROJECT:

518.22 Newdale Pitches and Community Facilities

DRAWING: Soft Landscape Strategy Sheet 2

NUMBER: 518.22.L02 Rev A

DATE: February 2024

STATUS: Planning

DRAWN: KL

CHECKED: AM

Scale 1:1000 @ A3



Notes  
1. Do not scale from this drawing.  
2. All dimensions and setting out are subject to detailed design. Any discrepancies to be reported to Red Kite Network Limited immediately.  
3. If in any doubt, ask.  
4. This drawing and the works depicted are copyrighted and no duplication may be made without prior consent from Red Kite Network Limited.  
5. Not to be used for construction.